



UNIT NO. 19/20 Vardhaman Service Ind. Estate,
Behind Punjab & Sind Bank,
LBS Marg, Vikhroli (West), Mumbai 400 083.
TEL : +9122 2578 3335 \ 3336 \ 3337
FAX : +9122 2578 3338 \ 2655
E-MAIL : FIRE1@VIMALFIRE.COM

UL LISTED SHOOTFIRE- 2000J" JRCP TYPE AQUA FOAM NOZZLE 2000J Regular Monitor

TECHNICAL DATA SHEET

1. GENERAL DESCRIPTION

The manually operated non-aspirating Foam Monitor made of Stainless Steel, capable to discharging 2000 US GPM (7570 LPM) at 100 psi (7 bar) inlet pressure over a range of 70 to 75 meters in horizontal direction and 35 meters in vertical direction. Foam monitors are very compact in construction and gives good flexibility of the operation while fighting with fire. Foam roportioning 3 % is done with help of water operated Jet Ratio Controller Pump (JRCP) suitable for feeding foam concentrate solution to the monitor nozzle from a minimum distance of 50 mtrs. The Foam Monitor has facility for converting Water/Foam jet to fog and vice-versa very quickly and easily, even during continuous operation. Foam Monitor is provided with self-locking swivel gear bearing for rotation in horizontal and vertical direction through hand wheel operation even under high operating pressures. A single fire fighter can manually operate the Foam Monitor with large flow capacity, long-range capability. The monitor assembly is designed to withstand the nozzle reaction force experienced during the operation of jet/ fog.

2. SALIENT FEATURES

1. High Discharge Capacity of 2000 US GPM (7570 LPM) at 100 psi (7 bar) inlet pressure
2. Excellent Horizontal throw of 70 to 75 meter long and above
3. Excellent Fog Jet throw of 20 meter & above.
4. Jet Ratio Controlled Pump (JRCP) Monitor can be placed 50 meter away from the foam Monitor.
5. Very compact in construction and gives good flexibility of the operation while fire fighting
6. Low Expansion, so less loss of foam due to breakage and thermal updraft and more cooling effect on burning surface.
7. Quick change over from jet to fog or spray even under water pressure with single firefighter.
8. Easy maneuverability in horizontal and vertical plane
9. Almost maintenance free

3. APPLICATION

The Monitor is highly effective with water and foam for fast knockdown of Fire at Oil & Gas Plants, Off-Shore & On Shore Platforms, Oil Refineries, Petroleum Storage Tanks & Depots, Chemical &

Fertilizer Plants, Steel Plants, Power Plants, Air Port Run-Ways, Ammunition Depots, Defence Stores, Naval Ships And Submarine, Ships & Oil tankers, Fire Fighting Vessels / Tugs, Ports & Jetties Etc.

4. EXPLODED VIEW

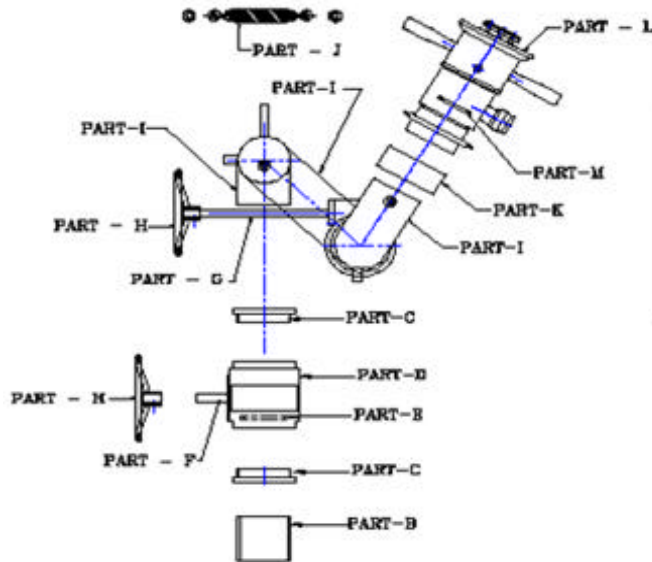

PART NO	DESCRIPTION	QTY.	MATL.
A	6" NB 150 # S.O.R.F. FLANGE	1 NO	SS 316
B	6" NB SEAMLESS SCH. 40	1 NO	SS 316
C	NECKRING	4 NOS	SS 316
D	6" WORM BEARING	2 SETS	SS 316/BRONZE
E	'O' RING	2 NOS	RUBBER
F&G	SHAFT	2 NOS	SS 316
H	HAND WHEEL	2 NOS	SS 316
I	6" NB SEAMLESS SCH 40 1D ELBOW	1 NO	SS 316
J	SPRING	2 NOS	SS 316
K	NOZZLE MOUNTING NECKRING	1 NO	SS 316
L	2000 GPM FOM NOZZLE JRCP TYPE	1 NO	SS 316
M	NOZZLE 'O' RING	1 NO	RUBBER

5. MATERIALS OF CONSTRUCTION

- | | |
|--------------------------------------|-------------------|
| 1. Monitor body, barrel | : SS 316 |
| 2. Swivel joint | : SS 316 / Bronze |
| 3. Discharge Nozzle (foam cum water) | : SS 316 |
| 4. Base Flange | : SS 316 |
| 6. Worm & Worm wheel | : SS 316 |
| 7. Foam control valve | : SS 316 |
| 8. Pick up pipe connection | : SS 316 |
| 9. Pick up tube at (JRCP) | : PVC |

6. TECHNICAL DETAILS

- | | |
|-------------------------------------|--|
| 1. Flow at 100 psi (7 bar) pressure | : 2000 US GPM (7570 LPM) |
| 2. Nozzle | : Non-aspirating type |
| 3. Induction Type | : By Aqua Powered inductor (JRCP) from minimum distance of 50 mtr & above from Nozzle. |
| 4. Induction Rate | : 3 % |
| 5. Monitor Elevation | : +90° & - 30° Vertical |
| 6. Rotation | : 360° Horizontal. |
| 7. Water way size | : 150 NB |
| 8. Pick up tube length at (JRCP) | : 3 mtrs long PVC tube |
| 9. Inlet Flange Size | : 150 NB ANSI B 165 150#flat face. |
| 10. Hydrostatic Test Pressure | : 21 bar. |
| 11. Finish/ Paint | : Fire red shade of Acrylic/PU/ Powder coating |

7. AQUA FOAM JET RATIO CONTROLLER PUMP

Water operated foam pump (JRCP) suitable for feeding foam concentrate solution to the monitor nozzle from min .distance of 50 mtrs in horizontal plane. The inlet & outlet of JRCP is provided with 63 mm. Male & female coupling respectively.

- | | |
|----------------------------------|--|
| 1. Material of Aqua Powered Pump | : SS 316 |
| 2. Inlet & Outlet Coupling | : 2 ½" Male/Female coupling |
| 3. Foam Induction Rate | : 3% |
| 4. Pick up tube | : PVC 3 Mtrs. Long fitted with suction Strainer of SS |
| 5. Delivery Distance | : Aqua Jet Controller Pump is capable enough to feed foam solution to the monitor nozzle from minimum 50 meters in horizontal plane. |

9. PERFORMANCE AT 100 PSI (IN STILL AIR CONDITION)

- | | |
|---|------------|
| 1. Water jet at 30° from Horizontal plane | : 75mtrs. |
| 2. Foam jet at 30° from Horizontal plane | : 70 mtrs. |
| 3. Fog jet at 30° from Horizontal plane | : 20 mtrs. |

10. APPROVAL: UL LISTED WITH FOLLOWING FEATURES

- | | |
|--------------------------|--|
| 1. Nozzle | : Non Air Aspirating Nozzle |
| 2. Monitor Solution Flow | : 2000 GPM |
| 3. Operating Pressure | : 100 PSI |
| 4. Induction | : By Aqua Powered inductor (JRCP) from minimum distance of 50 mtr & above from Nozzle. |

